



MODEL
ED
Extended Duty

EC HOISTS
for **SPECIAL**
APPLICATIONS



1/2 - 2 Ton

Made in USA

Extended Duty Hoists

COFFING ED Models - Extended duty service for special applications which require a hoist that exceeds the duty rating of basic EC models.

CAPACITIES & LIFTS - Rated loads from 1/4 to 2 Tons, with 10, 15, and 20-foot standard lifts. Other lifts available. Standard push button drop is 4-feet less than lift.

VOLTAGE & MOTOR OPTIONS - 230/460, three phase motors standard. Totally enclosed, fan-cooled motor keeps both motor and transmission from overheating. Consult factory for other voltage and speed options.

SUSPENSION OPTIONS - Rigid lug; plain, geared, and motorized trolleys.

DUTY CYCLE - Exceeds H4 duty service.

LOAD CHAIN - Zinc plated standard for corrosion resistance.

EXTERNAL STRAIN RELIEF - Secures to NEMA 3R push button station with extra strain relief protection.

ACCESSORIES - Full line of options to meet a variety of applications. See pages 25-31.

LIFETIME WARRANTY

● SPECIFICATIONS ●

ED Extended Duty Hoists

Capacity			Model * Number	No. of Chains	Motor HP	Lift Speed (fpm)	Headroom (in.)	Housing Dimensions (in.)			Net Wt. (lb.)
(lb.)	(kg) ††	(Ton)						H	W	L	
1000	500	1/2	ED(†)-1032	1	1	32	17 1/4	8 1/4	11 5/8	26 1/4	128
2000	1000	1	ED(†)-2016	1	1	16	17 1/4	8 1/4	11 5/8	26 1/4	130
4000	2000	2	ED(†)-4008	2	1	8	19 5/16	8 1/4	11 5/8	26 1/4	145

†† Metric rated option available.

* Lug, plain, geared or motorized trolley mounting

† Specify **ED** for rigid lug, **EDT** for plain trolley, **EDGT** for geared trolley and **EDMT** for motorized trolley models.

Note: For complete dimensional data, refer to Coffing Dimensional Databook



EC HOISTS for SPECIAL APPLICATIONS

MODEL EC Turnover Hoists



EC Turnover Model Hoists

COFFING EC Turnover Models - Specially modified EC Hoist designed for machining, assembly, or repair applications which require complete rotation and/or precise positioning of large, non-symmetrical work pieces.

CAPACITIES & LIFTS - Rated loads from 1/4 to 4 Tons. Lift stroke is 15-foot standard. Consult factory for longer lift strokes.

VOLTAGE - 230/460, three phase motors standard. Consult factory for other voltages and two speed motors.

SUSPENSION OPTIONS - Rigid lug mount only. Allows attachment to load hook of another hoist for vertical lifting.

TWO LOAD HOOKS - Color coded load hooks with corresponding push button for operator convenience.

OPERATION - Load hooks operate in opposite directions.

APPLICATION - Completely inverts virtually any shape load with use of simple slings and successive repositioning of load hooks.

ACCESSORIES - Full line of options to meet a variety of applications. See pages 25-31.

LIFETIME WARRANTY

Typical Application

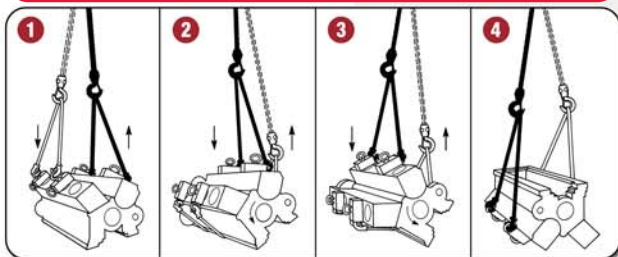

Engine block is raised straight up (1) by special cylinder lift rings, then rotated approximately 45° until one load hook (2) supports total weight. Sling is guided under block and attached to free hook (3). Hoist is then reversed (4) until block is inverted.

EC Turnover Hoists

Capacity			Model Number	Frame * Size	Load Chain Length (ft.)	Lift Stroke (ft.)	Motor HP	Lift Speed (rpm)	Headroom (in.)	Housing Dimensions (in.)			Net Wt. ** (lb.)
(lb.)	(kg) †	(Ton)								H	W	L	
500	250	1/4	EC-0516-TH	S	16	15	1/4	16	19 7/8	9 7/8	11 5/8	23 3/8	120
1000	500	1/2	EC-1016-TH	S	16	15	1/2	16	19 7/8	9 7/8	11 5/8	23 3/8	126
2000	1000	1	EC-2016-TH	S	16	15	1	16	19 7/8	9 7/8	11 5/8	23 3/8	138
4000	2000	2	EC-4016-TH	L	16	15	2	16	28 1/2	12 5/16	14 13/16	31 3/16	325
6000	3000	3	EC-6008-TH	L	34**	15	3	8	33	13 5/16	15 3/8	31 3/16	385
8000		4	EC-8008-TH	L	34**	15	3	8	33	13 5/16	15 3/8	31 3/16	390

† Metric rated option available.

* S = Small frame hoist, single or three phase. L = Large frame hoist, three phase only.

** Each load block is double-chained on 6000 lb. and 8000 lb. models.



1/4 - 4 Ton
Made in USA

